

# CATHOLIC DIOCESE OF MALINDI - CONSTRUCTION OF RESCUE CENTER FOR ABUSED CHILDREN AND SHELTER FOR CHILD MOTHERS

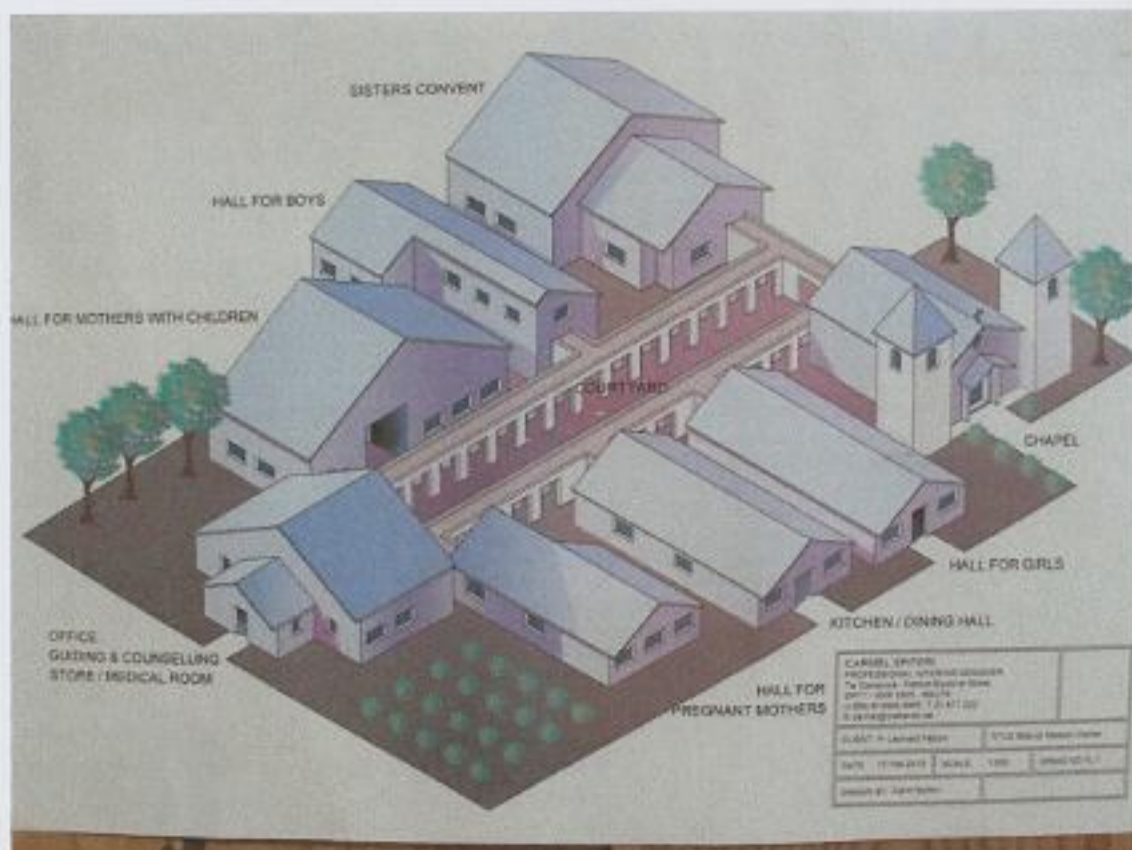

CATHOLIC DIOCESE OF MALINDI - CONSTRUCTION OF  
RESCUE CENTER FOR ABUSED CHILDREN AND SHELTER FOR  
CHILD MOTHERS



Name of Organization	Catholic Diocese of Malindi - Rescue Center
Project sites (Counties)	Kilifi, Lamu, Tana River
Address	Catholic Diocese of Malindi - Kenya
Contact Details	1573-80200 -Malindi Kenya
Title of Project	<b><i>Construction of Rescue Center for abused children and shelter for child mothers</i></b>
Project Location	Malindi County
Name of Applicant	Child Protection Desk-Malindi Diocese
Start - end date (month, year)	1 January 2013 - 30 June 2014
Total request in Kshs/Euros	35,147,139/ <b>351,471.39</b>
10% Local contribution	3,905.237.70
Contact Person	Fr. Bernard malasi
Title/Position	Director
Mobile telephone	+254-716224790
E-mail	bernmalamwa@gmail.com or malindidiocese@yahoo.com

CATHOLIC DIOCESE OF MALINDI - CONSTRUCTION OF  
RESCUE CENTER FOR ABUSED CHILDREN AND SHELTER FOR  
CHILD MOTHERS

## **INTRODUCTION**

### **Organization Background Information**

The Catholic Diocese of Malindi covers three Administrative counties namely Kilifi, Tana Delta and Lamu). The Diocese covers an area of 26,882 sq kms with a population of 598,717 people and bordering the Indian Ocean. It is one of the newly created Dioceses in Kenya having been established in the year 2000. The Diocese Administers to the people through 17 parishes namely Malindi, St. Francis Xavier- Kisumu Ndogo, Msabaha, Watamu, Gongoni, Marafa, Lango Baya, Mere, Tarasaa, Witu/Kipini, Mpeketoni, Hongwe, Hindi, Wema, Chakama, Baharini, and Lamu.

County	Sub County	Est. Population	# of Households	Area (Sq. km.)	Density per Sq. km
KILIFI	Malindi/Magarini	400,514	73,330	7,792.2	51
Tana River	Tana Delta	96,664	18,790	15,614.0	6
Lamu	Lamu	101,539	22,184	6,273.1	16

### **Vision Statement**

We the Catholic Diocese of Malindi inspired by the Gospel message/values are reaching out to the person so that all may have life and have it to the full.

### **Mission Statement**

We the Catholic Diocese of Malindi seeks to evangelize to the people by responding to spiritual, social, economic, political and cultural needs based on the Catholic teachings, using the principles of hope, faith, and love; through collaboration with other willing



CATHOLIC DIOCESE OF MALINDI - CONSTRUCTION OF  
RESCUE CENTER FOR ABUSED CHILDREN AND SHELTER FOR  
CHILD MOTHERS

stakeholders so as to achieve full human development in light of morality, equity, transparency, accountability, justice and truth.

### PROBLEM STATEMENT

The high incidence of household poverty was found to be the biggest impediment on concerted efforts to eradicate the problem of sexual exploitation of children. Other factors are: supply and demand factors; gullibility of young girls; child neglect; high levels of dependency on benefits of the practice; spontaneity of sexual urge due to drug and substance abuse; parental irresponsibility over children; family pressure; bad example from parents; negative media influence; family pressure and peer influence; laxity in law enforcement due to poor legal and administrative systems.

In trying to survive, the children may fall pregnant, be sent away from home and likely end up at the mercy of abusers. In cases of incest these children have nowhere else to go due to stigma and fear of rejection. Many mothers and children cannot even speak about the abuse in the home and thus the cycle of abuse continues. However, when allowed to speak, children will open up and tell their story. More often than not, they don't even recognize that whatever has happened to them is abuse.

Below are some striking statements quoting exactly what the children reported in some of the cases we have handled.

### *THE CHILDREN'S VOICES*

*My father started sleeping on me when I was nine years old. I did not know what it was until recently when I got tired of it. I could not tell my mother because he threatened to stab me. I go with him to the hospital every month to collect medicine for typhoid. That is why I was with him last month when he took me to lodging in ..... He slept on me for one hour. (Girl 13 years)*

CATHOLIC DIOCESE OF MALINDI - CONSTRUCTION OF  
RESCUE CENTER FOR ABUSED CHILDREN AND SHELTER FOR  
CHILD MOTHERS

*When my mother left, my father started sleeping with me. I was only nine. I told my teacher but I had nowhere to go and some people did not believe me. So everyday my father did it and there is nothing I could do. He also started on my younger sister and my last born brother. Now I am pregnant (Girl 15 years)*

#### PROJECT GOAL

The main goal of this project is to construct a rescue centre/shelter that will cater for the immediate needs of abused children including expectant girls and child mothers rescued from an abusive environment.

This will be done with the Children's office, Ministries of Health and Education, Police and relevant stakeholders as technical advisors

#### PROJECT ACTIVITIES

The project will be undertaken in the following stages according to priority:

1. Perimeter wall fence.
2. Girls dormitory
3. Expectant girls' shelter
4. Child mothers' shelter
5. Boys Dormitory
6. Kitchen /dining hall
7. Administration block: All personnel offices will be situated here.

**CATHOLIC DIOCESE OF MALINDI - CONSTRUCTION OF  
RESCUE CENTER FOR ABUSED CHILDREN AND SHELTER FOR  
CHILD MOTHERS**

8. Chapel

9. Convent

10. Pavements

**Budget**

See attached budget and picture of the grounds

<b>PROPOSED BUDGET FOR CATHOLIC DIOCESE RESCUE CENTRE</b>					
<b>NO.</b>	<b>ITEM</b>	<b>UNITS IN Sq meters</b>	<b>COST PER ITEM</b>	<b>TOTAL COST IN KSHS</b>	<b>TOTAL COST IN EUROS</b>
1	Expectant Girls Shelter	74.7	35,000	2,614,500	26,145.00
2	Dining Hall/ Kitchen	75.9	35,000	2,656,500	26,565
3	Girls Dormitory	118.08	35,000	4,132,800	41,328
4	Chapel	77.5	30,000	2,325,000	23,250
5	Covent	145.04	40,000	5,801,600	58,016
6	Boys Dormitory	76.4	35,000	2,674,000	26,740
7	Child Mothers Hall	131.88	35,000	4,615,800	46,158
8	Administration Block	103.56	35,000	3,624,600	36,246
9	Pavements	111.96	1,500	167,940	1,679.40
10	Perimeter wall fence	1200	3,500	4,200,000	42,000
11	Cost of Land	0	709	1,500,000	15,000
12	Personnel	12	240,000	2,880,000	28,800
13	Contingencies		5%	1,859,637	18,596.37



**CATHOLIC DIOCESE OF MALINDI - CONSTRUCTION OF  
RESCUE CENTER FOR ABUSED CHILDREN AND SHELTER FOR  
CHILD MOTHERS**

	<b>GRAND TOTAL</b>			<b>39,052,377</b>	<b>390,523.77</b>

**NB**

Local Contribution will be 10% of the grand total cost. I.e  
**3,905,237.7{ KSHS}**

Therefore amount requested is **Kshs 35,147,139/**

**Euros 351,471.39**

